



STEP UP

"Taking h Y' bYl hghYd to reach our community with the gospel and teach more people how to follow Jesus step by step."

Capital Campaign Information



NEWPOINT
CHURCH



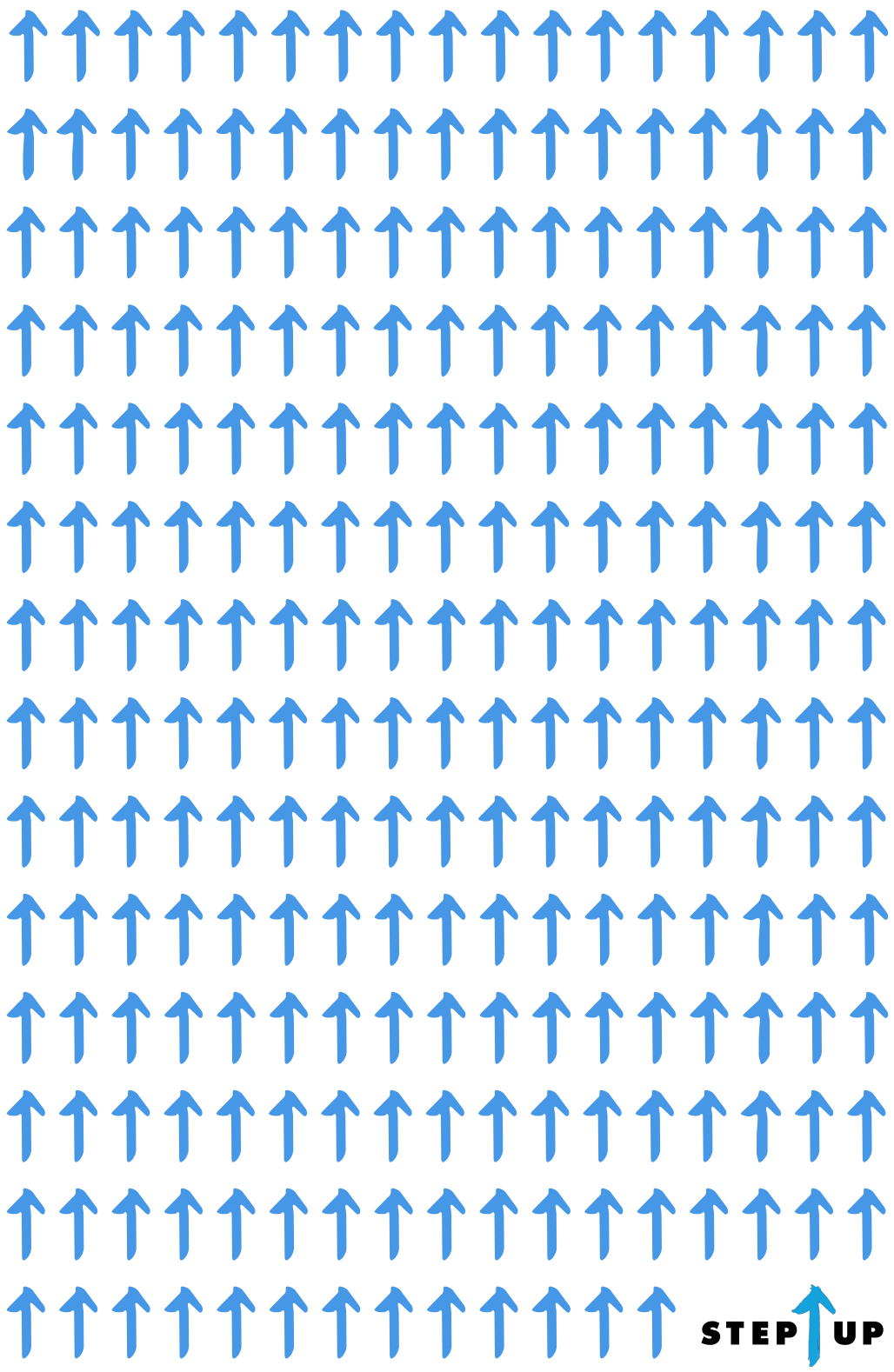

STEP  **UP**

Dear Family and Friends,

It's hard to express in words how amazed I am about the wondrous things God has done through NewPoint Church since we launched just a short time ago on Easter Sunday, 2015. Setting out with a vision and a handful of faithful friends, little did we know that God would very quickly meet and exceed our expectations of what He could do in our community.



Over the last year and a half we have seen NewPoint Church grow from 14 people meeting in a living room to more than 160 people attending weekly at our temporary location, the Carolyn Renfro Event Center.

In this short amount of time, we have had over 50 people make Jesus the Lord of their life, follow through in baptism, and begin to take next steps in their walk with Christ.

As we continue to reach more people, our current facilities are quickly approaching maximum capacity. Over the last year, our leadership team has been diligently praying about the next step God has in store for NewPoint Church so we can continue to accomplish our mission of reaching people in our community.

Our leadership team strongly believes that God has answered those prayers by opening up the door for NewPoint Church to purchase and remodel a 17,500 sqft building at the corner of Hartford Ave. and Union St. in Ponca City. This building would be the new permanent home of NewPoint Church.



We are asking that you would join with us to pray through this opportunity to expand our mission in our community. Its going to take a joint effort from all of us that call NewPoint Church home to make this dream a reality. As you read through the rest of this brochure, may the Lord inspire you to Step Up and join in!

Blessings,

Kyle Megenity

Kyle Megenity
Lead Pastor

Needs and Challenges

Worship Space

Just like a goldfish will only grow as large as the bowl it lives in, a church will only grow so far as it has room for new people to come in. NewPoint has been hovering around maximum capacity for several months now. We need a worship space with more seats so we can reach more people.



Nursery and KIDS Church

In our current rental facility, we only have access to four total Nursery and Kids classrooms. This means, that as we have grown, these rooms have quickly become overcrowded. At the Renfro Center there is no possibility for future expansion.



YOUTH Ministry

Our Wednesday night 6th-12th grade YOUTH ministry has grown tremendously over the last year. The current space is too small for our students and also limits the type of activities we can do. In addition, we pay extra fees to meet in this room on Wednesday nights.



Next Steps

Our mission is to see people taking next steps in their relationship with Christ. A large part of this ministry involves 1 on 1 counseling and prayer during the Sunday service. Our current building does not have room for a private place to meet.



Community Missions

NewPoint Church is much more than what takes place on Sunday mornings. For us, community missions is a priority, and this means getting out and touching real lives that might never step foot in our building. This new location, on the corner of Hartford and Union, is within walking distance of several lower income neighborhoods, as well as Paladin Apartments and Meadowbrook Village mobile home park, each with over 200 units. This will be a prime place to launch out and do ministry in Ponca City for years to come.



On-Site Ministry

Currently, NewPoint is a completely mobile church as we have to set up each week from scratch. Our nursery doubles as our storage room throughout the week leaving it relatively unusable. Anytime we want to utilize the building another time for ministry other than Sunday morning, we pay an extra fee to rent those rooms. In this building we would finally be able to hold on-site classes, trainings, discipleship, and a host of other community ministry events.

Building Information

- 17,500 Total Square Feet.
- 350 seat Auditorium. (Doubles our current capacity)
- Offices for Staff.
- Seperate YOUTH/KIDS Area.
- Seperate Nursery Area.
- Seperate Next Steps Room for decisions and counseling.
- Large open gathering space for fellowship before/after services.
- Commercial Kitchen.
- Space for ministry events throughout the week.



Floor Plan

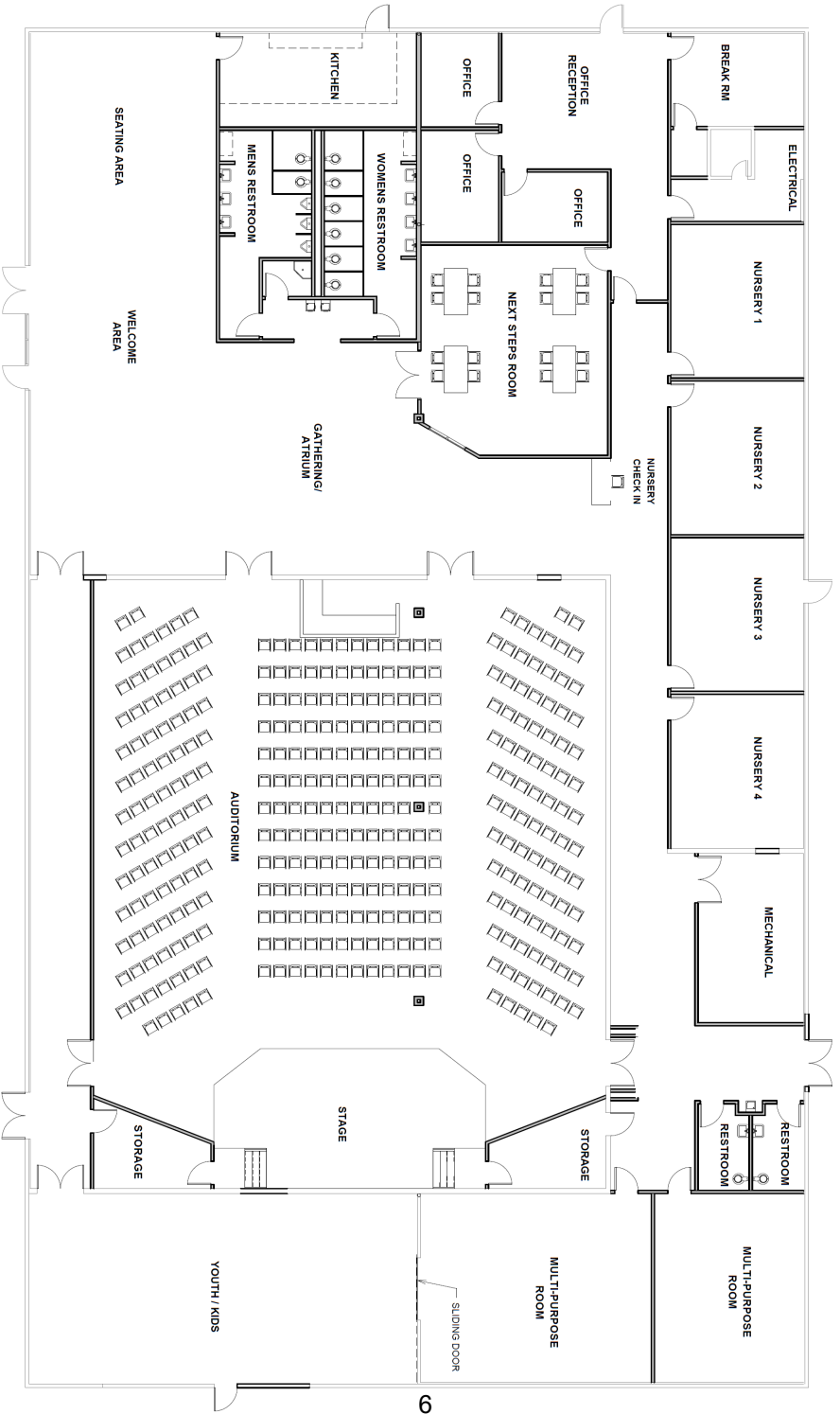

Frequently Asked Questions

What is the "Step Up" Campaign?

The "Step Up" campaign is a three year capital fundraising campaign to raise a portion of the purchase and remodel costs of the new church building. Our goal is \$300,000. The "Step Up" Campaign provides an opportunity for everyone to invest in the future home of NewPoint Church through a one time gift or a pledge of monthly gifts paid out over the three year campaign.

What will the new building consist of?

NewPoint's new home will be a 17,500 sqft building at the corner of Union and Hartford in Ponca City. This building will consist of a 350 seat worship center, a large open gathering and fellowship space, a Next Steps room for ministering to those who respond during the service, 6 Nursery classrooms, a large YOUTH and KIDS Ministry area, offices for church staff, and a kitchen.

How much will it cost?

We will break down the total building remodel into at least two phases. The initial phase to get us into the building is estimated around \$800,000. The following phases to finish out the building will raise the total project cost to around \$1.5 million.

The Step Up campaign is designed to raise \$300,000 for the down payment of the total project expense. We would like to raise the first \$50,000 of our goal in the first couple of months of the campaign, and the final \$250,000 over the course of the three year commitment.

Estimated Project Cost

\$250,000 - Building Purchase

\$550,000 - Phase 1 Remodel

- Worship Space, Gathering Space, Bathrooms, Nursery/KIDS Classrooms, Next Steps Room, Chairs, Audio/Visual.

\$250,000 - Land for Parking and Future Expansion

\$450,000 - Phase 2 Remodel

- Offices, Kitchen, Dedicated YOUTH/KIDS Room, Additional Nursery Rooms and Bathrooms.

\$1,500,000 - Total Estimated Project Cost

STEP UP

What are the church's next steps?

- 1) The Leadership Team of NewPoint Church is unanimously proposing that we as a church move forward with the purchase and remodel of the building at 1915 N. Union. We will hold a specially called business meeting on Sunday evening, November 13th, to answer any final questions and have a membership vote to either accept or reject the Leadership Team's proposal.
- 2) If the vote passes, we will begin our Step Up campaign with a "Launch Offering" on Sunday, November 20th. On this day we will also be accepting your pledges for what you will commit to give toward the new building over the next 3 years.
- 3) In January 2017, we will purchase the building at 1915 N. Union and begin the process of remodeling. The goal will be to be finished with Phase 1 of the remodel and begin holding worship services in the building around Easter Sunday, April 16th, 2017.
- 4) Step Up commitments will continue to be fulfilled over the course of the next three years to reach our campaign goal of \$300,000.
- 5) The final phases of the remodel will be completed over the next three years as the campaign goal is fulfilled.

What's my next step?

We are asking everyone who calls NewPoint Church their church home to get involved and Step Up to make this vision a reality. It will take everyone sacrificially giving in order to make this happen. Here are ways you can Step Up:

- 1) **PRAY**-Pray about what God would lead you to give toward the Step Up campaign. (reference the chart on the next page for options)
- 2) **GIVE**-Consider giving an up front "Launch Offering" on Sunday, November 20th. This will help us kick-start the Step Up Campaign and construction. Secondly, pledge to give a set monthly amount, over and above your regular tithe, to the Step Up campaign over the next three years. You can set up your monthly pledge amount online at www.newpoint.church/give.
- 3) **WORK**- There will be several opportunities for our laypeople to get involved in the building remodel in order to save on labor expenses.

How are we going to meet our goal?

We believe that if God has given us this vision, then God will provide the resources to carry it out. We understand that not everyone has the same resources or ability to give. But, we do believe that God has blessed all of us on some level so that we can give.

Below are three levels of giving with various suggested amounts and monthly payments that when added together will reach our goal of raising \$300,000 over the next 3 years. We are simply asking that you pray about what God would have you to give and then commit to Step Up by giving a Launch Offering and setting up monthly gifts to the Step Up Campaign over and above your regular tithe.

NewPoint 3 Year Step-Up Campaign - \$300,000 Goal				
		Giving Options		
	# Gifts Required	One-Time Gift	36 Monthly Gifts of...	Cumulative Church Total
Top Level	1	\$30,000	\$834	\$30,000
	1	\$23,000	\$639	\$53,000
	2	\$15,000	\$417	\$83,000
	3	\$12,000	\$334	\$119,000
Mid Level	5	\$7,500	\$209	\$156,500
	8	\$5,700	\$159	\$202,100
	10	\$3,800	\$106	\$240,100
	12	\$1,900	\$53	\$262,900
Base Level	12	\$750	\$21	\$271,900
	74	Under \$750	\$...	\$300,000
Totals	128			\$300,000

How to create margin in my life so I can give.

The way we LIVE is the way we give.

Capital stewardship campaigns rely on church members making gifts over and above their current level of giving to the operating budget needs of the church. The best path to increased giving is the spiritual path, where we set our hearts on things above. Financial priorities then take shape from the spiritual priorities.

One way of defining this is “Lifestyle Stewardship,” a term used to describe a level of giving that affects one’s living. Always with us is the temptation to give in such a way that it makes little impact on how we live. The challenge of Lifestyle Stewardship is to boldly and prayerfully find ways to do just that – to let our giving touch our living!

King David declared, “I will not sacrifice to the Lord my God burnt offerings that cost me nothing” (2 Samuel 24:24 NIV). David understood that the value of the gift presented to God is determined by its value to the giver. The greater the gift’s value and significance to the giver, the greater its worth before the Heavenly Father. The gift that would touch the heart of God must first touch the heart of the giver! This is the spirit of Lifestyle Stewardship: *“If it is for my God, my gift must have meaning and value to me.”*

Lifestyle Giving is a level of giving that affects me: my plans, my activities, my attitude and my approach to life. It means giving up something in one area so that I can give more of myself in another. The three keys to effectiveness in Lifestyle Stewardship are:

- 1) **Reassess lifestyle.**
- 2) **Rearrange priorities.**
- 3) **Reallocate resources.**

Many Christians have been amazed at how much more they could give after going through this process. The following seven steps are offered to help you in this regard. These steps also include practical examples from other churches.

1. Priority Budgeting

Many families will choose to rearrange their priorities and give up something in their current budget in order to give more. Priority budgeting may mean postponing a planned expenditure such as a new car, vacation, home remodeling or other major purchase. Many Christians find a way to give more through sacrificial commitments made in faith coupled with priority budgeting.

2. Redirect Present Expenditures

Often, families have significant short-term expenditures for special needs. One example is the large expenditure a family incurs for a child to attend college. One family might realize that their daughters would be graduating from college during the three years of the capital campaign and, as a result, they were able to increase their commitment to the years two and three of the campaign by thousands of dollars. Another example would be the cash flow that is freed up when a loan is paid.

3. Increased Income = Increased Giving

Some people receive periodic increases in salary or bonuses from their employers. The temptation for many of us is to increase our lifestyle to fit the higher income. In some instances, a family might decide that they will commit the full amount of salary increases.

4. Giving from Excess

A young man decided that two collectors' baseball cards worth over \$20,000 he had been holding for a number of years would be the most appropriate means of sacrifice for his family. Some families save money over a period of years for a special project. A couple had saved \$80,000 to build a lake cabin. When their church entered a capital stewardship campaign, they decided the needs of the church were greater than their need for a second home.

5. Unexpected Cash

Often, people pray for God to show them a way they can give beyond what they can presently see or afford. Sometimes, the answers come unexpectedly. A couple had been praying for weeks about their commitment to the church capital campaign. Much to their surprise, they received an inheritance of several thousand dollars. They gave the entire amount to their church as part of their three year commitment, in addition to a commitment from their regular income.

6. Extra Work

Some family members have extra time they would be willing to use in a part-time job to be able to give more to the church. This is particularly true for families whose children are grown and away from home and for semi-retired or retired couples. One man was in the process of retiring when his church entered a campaign. He and his wife secured new jobs and gave the first three years of their retirement income to the capital campaign.

7. Appreciated Assets

Many people own assets that have achieved unrealized gains in value over the years. That is good news. The bad news is that if these assets were sold, a significant portion of the gain would be lost to taxation. Gifts of appreciated assets — typically investment securities or real estate — can be very advantageous to both the donor and to the church. By transferring ownership of the asset to the church, the donor avoids income taxes on the sale of the asset. Unlike gifts of cash that have already incurred an income tax, gifts of appreciated assets avoid the incurrence of capital gain tax. In addition, the donor receives an income tax charitable deduction for the full market value of the asset. That, in effect, makes these gifts less costly to make. Before making a commitment of this type, please consult your CPA, tax attorney or other financial advisor.

Planning Your Giving

Giving does not have to be in equal increments over the three-year period of the campaign. You might be able to give more in the third year than the first two. As you think about your financial commitment to the campaign, think not of just your potential to give right now, but also of your potential to give in the future. It might be that you can make a three-year commitment in which 20 percent is given in the first year, 30 percent in the second year and 50 percent in the third.

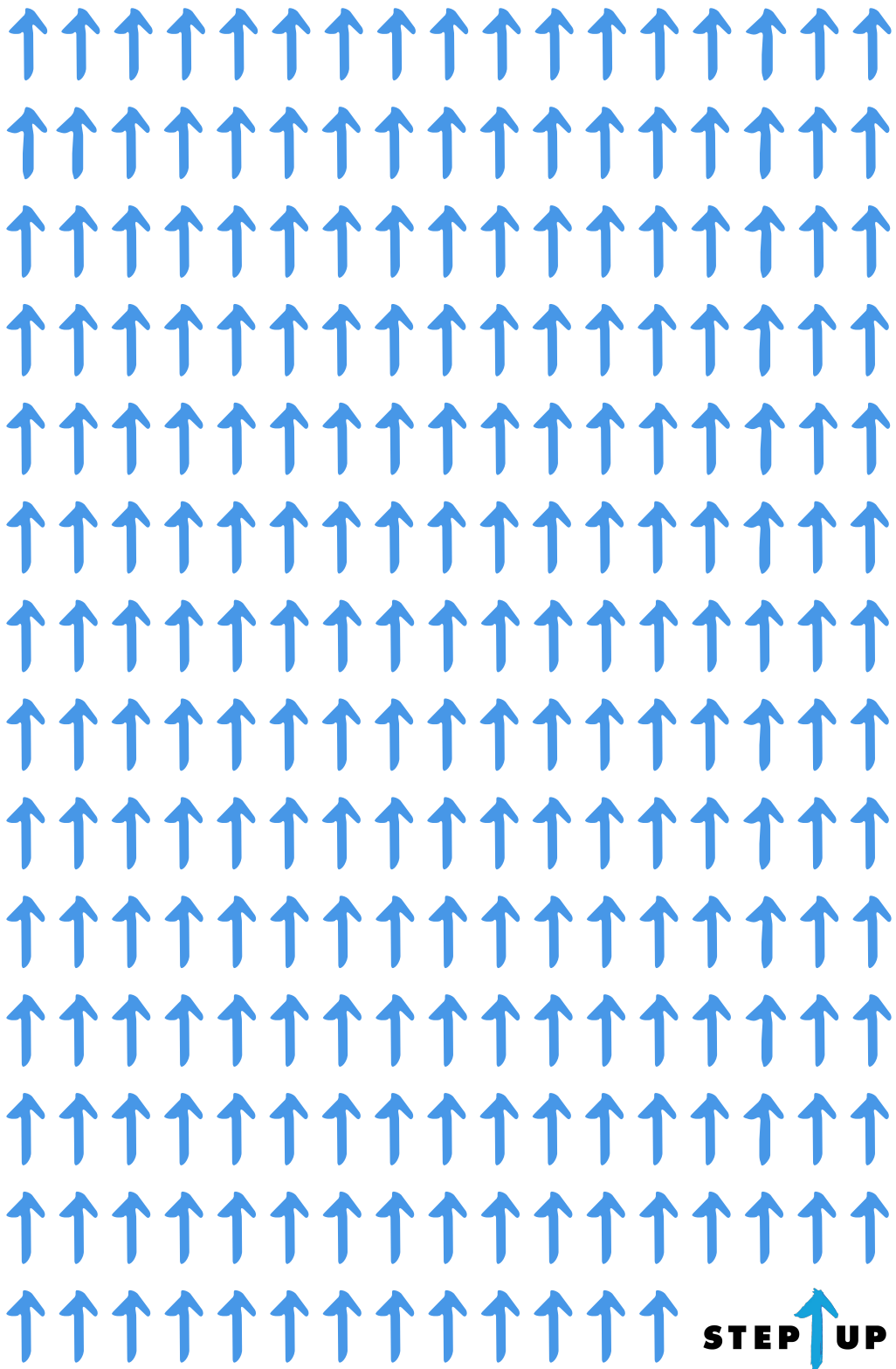

STEP UP



newpoint.church

